



CAFE MOSKAU



**PURE ELEGANCE MEETS HISTORY
WITH MODERN INFRASTRUCTURE**

Cafe Moskau
Karl-Marx-Allee 34
10178 Berlin
www.cafemoskau.com

Fon: +49.30.470 807 77
event@cafemoskau.com

EVENT SPACES



This architectural icon was built in 1964 on one of the capital's most popular streets: Karl-Marx-Allee in the heart of Berlin.

As a wine bar, nightclub and tea shop, the property was an eclectic mix of everything and a central meeting place for A-listers. After extensive renovations, the former restaurant re-opened in 2009 as a multi-purpose venue.

The heritage-listed establishment is particularly distinguished by its historic elements. Numerous details have been preserved from its early years giving it a unique charm. These include the elaborate wall mosaics, the illuminated lettering and the Sputnik satellite at the main entrance.

The floor-to-ceiling windows and atrium style are additional trademarks of the building, whose light-filled rooms offer patrons generous, unparalleled transparency.



EVENT SPACES



Almost 2,600 sq m of function space stretches over two floors providing enough room to hold any kind of event. The heart and soul of the venue are the two large halls - „Almaty“ on the ground floor and „Moskau“ (Moscow) on the upper level.

10 more rooms offer lots of space for workshops, lounges, buffets and much more.

To guarantee you maximum flexibility the entire venue comes without furniture and almost all rooms feature mobile partition systems, which enable easy modifications and variations.

A curtain system with blackout curtains allows to darken the rooms for projections.

Cafe Moskau includes two popular outdoor areas, which are ideal for receptions, catering and breaks outdoors.

The Atrium in the center of Cafe Moskau enables direct access to the foyers, the hall Almaty, and the rooms Jerewan (Yerevan), Duschanbe (Dushanbe) and Bischkek (Bishkek).

The Rosengarten (rose garden) with its very own charm, water feature and roses enables direct access to the rooms Asgabat, Duschanbe (Dushanbe) and Jerewan (Yerevan).

Get impressed by the charm of Cafe Moskau and arrange a site inspection with our team.



We are looking forward to welcoming you!

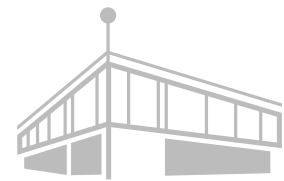

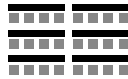

CAFE MOSKAU
BERLIN

MEASUREMENTS & SEATING OPTIONS

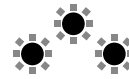
SPACE	AREA	HIGHT					LIST PRICES PER DAY*
entire venue incl. outdoor spaces	2.596,50 m²						19.500 €
Ground floor**	954,50 m²		Pax	Pax	Pax	Pax	9.750 €
Almaty	382 m ²	3,50 m	375	182	288	230	5.000 €
Asgabat	160 m ²	3,50 m	141	72	108	100	2.500 €
Duschanbe	67 m ²	3,50 m	24	15	24	-	1.500 €
Jerewan	67 m ²	3,50 m	20	-	-	20	1.500 €
Bischkek	81 m ²	3,50 m	78	30	42	40	1.500 €
Foyer Baku	105 m ²	3,50 m	-	-	-	-	-
Foyer Taschkent	73 m ²	3,20 m	-	-	-	-	-
Office (up to 8 Pax)	19,50 m ²	3,50 m					
Upper floor**	1020 m²						9.750 €
Moskau	446 m ²	3,90 m	433	232	378	280	5.000 €
Vilnius	66,50 m ²	3,50 m	64	25	36	30	1.500 €
Tallinn	60 m ²	3,50 m	46	24	30	30	1.500 €
Riga	65 m ²	3,50 m	46	24	30	30	1.500 €
Minsk	88 m ²	3,50 m	63	34	36	30	1.500 €
Chisinau	112 m ²	3,50 m	108	-	-	-	1.500 €
Foyer Kiew	113,50 m ²	3,50 m	-	-	-	-	-
Foyer Tiflis	69 m ²	3,50 m	-	-	-	-	-
Outdoor spaces							
Rosengarten	400 m ²		-	-	-	-	1.000 €
Atrium	222 m ²		-	-	-	-	1.000 €
Basement							
Sputnik	127 m ²	2,80 m	98	39	-	-	1.000 €

The maximum capacity for each floor is 800 people. The seating numbers are benchmarks and may depend on the concept and set-up. All prices are net prices and are exclusive of VAT.

Additionally we charge costs for power, water, staff and cleaning. A 10 Mbit/s network (up- and download-rate of 4 Mbit/s) for internal usage is included. All specifications are subject to change and have to be inspected on-site.

* 50% of the listed price is charged for set-up and dismantling days.

** No rental of single spaces.v

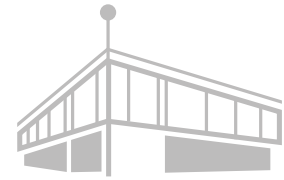

CAFE MOSKAU
BERLIN

FLOOR PLAN



Ground floor

- barista/tea
- **ALMATY**
Floor space: 382 sq m
Ceiling height: 3,50 m
 - **ASGABAT**
Floor space: 160 sq m
Ceiling height: 3,50 m
 - **BISCHKEK**
Floor space: 81 sq m
Ceiling height: 3,50 m
 - **DUSCHANBE**
Floor space: 67 sq m
Ceiling height: 3,50 m
 - **JEREWAN**
Floor space: 67 sq m
Ceiling height: 3,50 m
 - **FOYER EAST TASHKENT**
Floor space: 73 sq m
Ceiling height: 3,20 m
 - **FOYER WEST BAKU**
Floor space: 105 sq m
Ceiling height: 3,50 m
 - **OUTDOOR AREA:**
 - **ATRIUM**
Floor space: 222 sq m
 - **ROSENGARTEN**
Floor space: 400 sq m
- 1 Cloakroom east
2 Cloakroom west
3 Elevator east
4 Cloakfit
5 Elevator/ Cloakfit west
6 Catering Backstage
7 Office CAFE MOSKAU
8 Production office
..... Mobile partition

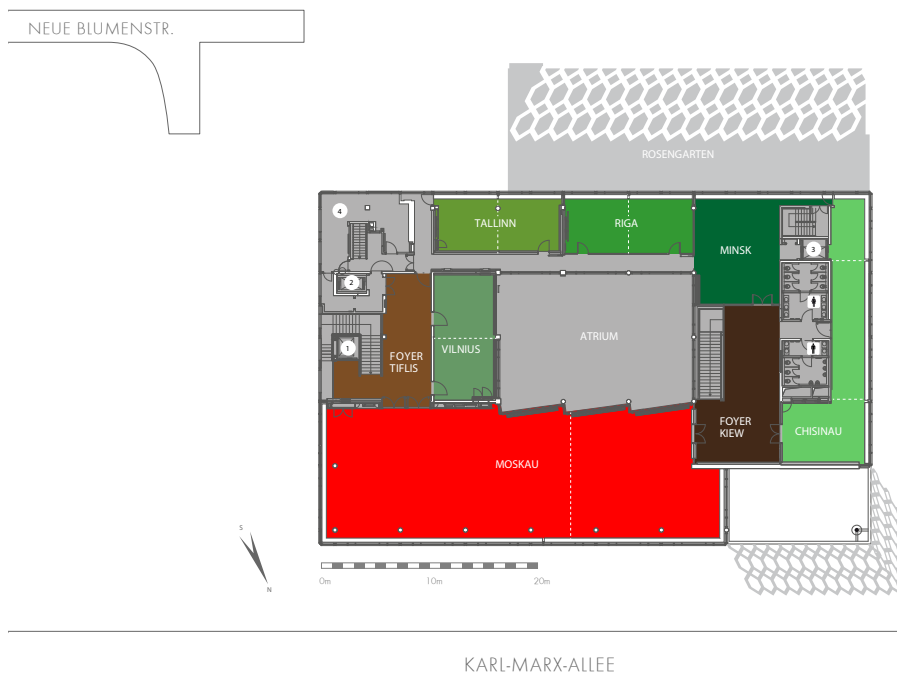

Upper floor

- barista/tea
- **MOSKAU**
Floor space: 446 sq m
Ceiling height: 3,90 m
 - **CHISINAU**
Floor space: 112 sq m
Ceiling height: 3,50 m
 - **TALLINN**
Floor space: 60 sq m
Ceiling height: 3,50 m
 - **RIGA**
Floor space: 65 sq m
Ceiling height: 3,50 m
 - **VILNIUS**
Floor space: 66,5 sq m
Ceiling height: 3,50 m
 - **MINSK**
Floor space: 88 sq m
Ceiling height: 3,50 m
 - **FOYER EAST TIFLIS**
Floor space: 99 sq m
Ceiling height: 3,50 m
 - **FOYER WEST KIEV**
Floor space: 113,5 sq m
Ceiling height: 3,50 m
- 1 Elevator east
2 Cloakfit east
3 Elevator/ Cloakfit west
4 Catering Backstage
..... Mobile partition

DIVERSE SERVICES

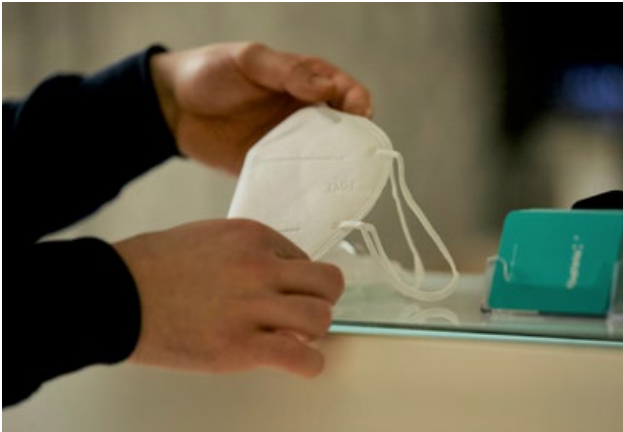

CONCEPT OF HYGIENE

In accordance with the latest ordinance to control the progressive spread of SARS-CoV-2 Coronavirus and taking into account the current SARS-CoV-2 Infection Protection Ordinance, we will create an individual concept of hygiene for your event. The aim is to hold a safe event within the scope of all given regulations in the context of the current pandemic situation.

Our certified hygiene officer will approve and certify the concept.



STAFF

We have a large network of competent, experienced service providers available to assist you in various areas. Starting from barista to barkeeper up to first aid team, photographer, hosts/hostess or security.

We are more than happy to support you with your staff planning.



BEVERAGE PACKAGES

From a welcome coffee at the beginning of the event to a long drink during the get-together in the evening - our beverage packages offer you full flexibility and are created individually according to your event concept.

DIVERSE SERVICES



BRANDING SPACES

When it comes to branding your event, the exterior facades of Cafe Moskau feature two banner spaces providing room for your personalised banner with high visibility.

Another branding option could be the plotting of the window facade, the mobile bar system or the wardrobe counter.



INTERNET

All event spaces at Cafe Moskau are full Wifi-enabled (bandwidth may be upgraded from 10 Mbit/s to 1 Gbit/s (synchronously)). Let us know your needs and we'll draw up a tailor-made quote. When using the Wifi, you will be given personalised access details in advance.



MOBILE BARSYSTEM

Our mobile bar system includes bar elements and shelves with coloured LED lights as well as fridges. All elements can be branded.

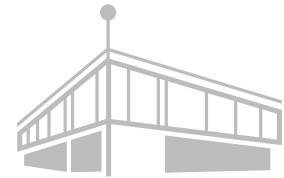

CAFE MOSKAU
BERLIN

CONTACT & PARTNER

LOCATION

Cafe Moskau
Karl-Marx-Allee 34
10178 Berlin

DELIVERIES

Neue Blumenstraße 13

OFFICE

Cafe Moskau GmbH
Milastraße 2
10437 Berlin

ENQUIRIES & VISITS

Sales Team
Fon +49.30.470 807 77
event@cafemoskau.com

EVENT ORGANISATION & QUESTIONS CONCERNING PRODUCTION

Production Team
produktion@cafemoskau.com

SECURITY

FSB-Security
Jörn Ullmann
joern.ullmann@fsb-security.com

CATERING

Einhorn Restarautions GmbH
Bernhard Braig
Fon +49.30.343 354 0
bernhard.braig@einhorn-catering.de

Fuchs + Gans GmbH
Gernot Karger & Paula Möhring
Fon +49.30.804 935 69
info@fuchsundgans.com

Hoflieferanten Berlin
Michael Lammert
Fon +49.30.200 086 611
lammert@hoflieferanten.berlin

Kochbox-Event Berlin GmbH
Katharina Müller
Fon +49.30.857 426 16
info@kochbox.com

Wild & Wiese GmbH & Co. KG
Ralf Dekorsy
Fon +49.30.657 779 01
ralf.dekorsy@wildundwiese.de

FURNITURE & DECORATION

Party Rent Berlin
Katharina Riedesel
Fon +49.30.200 061 513 7
katharina.riedesel@partyrent.com

LIGHT & SOUND

AMBION GmbH
Mathias Kaminski
Fon +49.30.726 278 425 0
cafemoskau@ambion.de

HOTEL

Hotel Amano Grand Central
Julia Herchenbach
Fon +49.30.400 300 210 1
Heidestraße 62, 10557 Berlin
herchenbach@amanogroup.com

Hotel Amano
Julia Herchenbach
Fon +49.30.400 300 210 1
Auguststraße 43, 10119 Berlin
herchenbach@amanogroup.com

DRIVER SERVICE

BerlinMobil Frank Richert GmbH
Doreen Plischkaner
Fon +49.30.422 199 14
plischkaner@berlinmobil.de

LOCATION & ARRIVAL

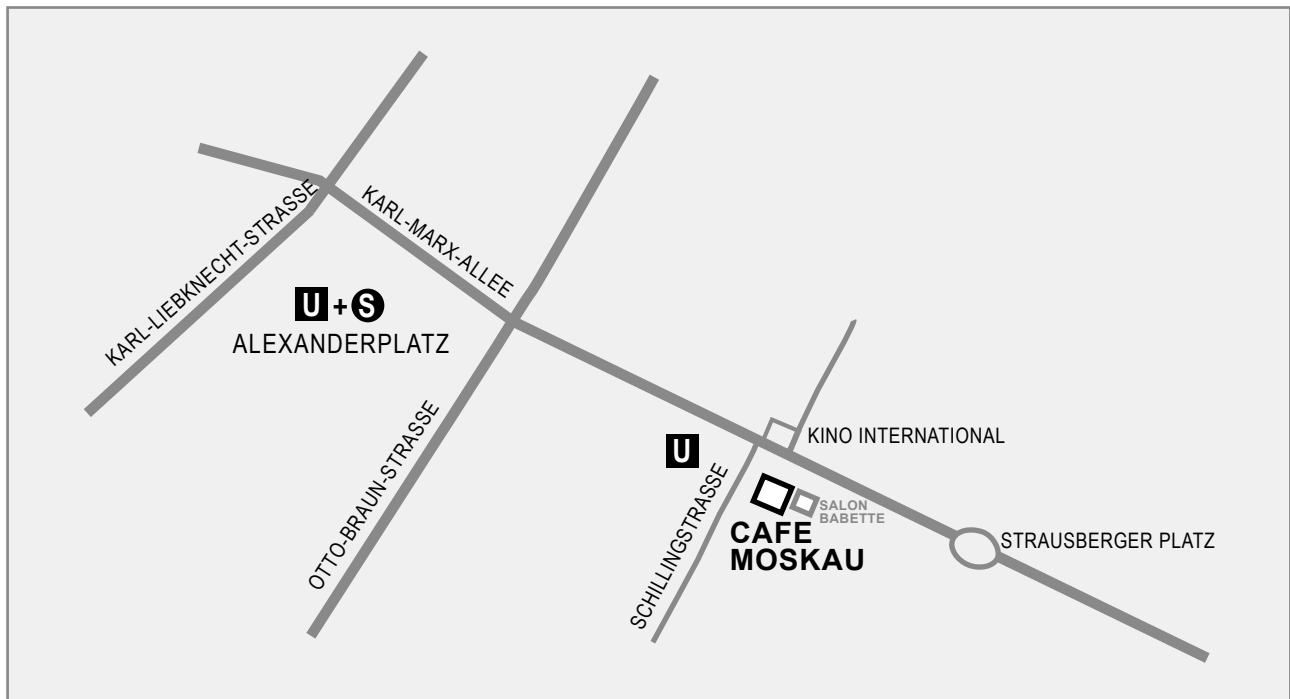

Cafe Moskau is located in Berlin-Mitte, a five minute walk from Alexanderplatz and directly in front of underground station Schillingstraße.

PUBLIC TRANSPORTATION

From Alexanderplatz: underground line U5 to Schillingstraße

From Hauptbahnhof (main station): underground line U5 to Schillingstraße

From airport BER: Regional trains FEX/ RE7/ RB 14 to Hauptbahnhof (main station), underground line U5 to Schillingstraße

PARKING

There is sufficient public parking available.