



# CAFE MOSKAU



**PURE ELEGANCE MEETS HISTORY  
WITH MODERN INFRASTRUCTURE**

Cafe Moskau  
Karl-Marx-Allee 34  
10178 Berlin  
[www.cafemoskau.com](http://www.cafemoskau.com)

Fon: +49.30.470 807 77  
[event@cafemoskau.com](mailto:event@cafemoskau.com)

## EVENT SPACES



This architectural icon was built in 1964 on one of the capital's most popular streets: Karl-Marx-Allee in the heart of Berlin.

As a wine bar, nightclub and tea shop, the property was an eclectic mix of everything and a central meeting place for A-listers. After extensive renovations, the former restaurant re-opened in 2009 as a multi-purpose venue.

The heritage-listed establishment is particularly distinguished by its historic elements. Numerous details have been preserved from its early years giving it a unique charm. These include the elaborate wall mosaics, the illuminated lettering and the Sputnik satellite at the main entrance.

The floor-to-ceiling windows and atrium style are additional trademarks of the building, whose light-filled rooms offer patrons generous, unparalleled transparency.



## EVENT SPACES



Almost 2,600 sq m of function space stretches over two floors providing enough room to hold any kind of event. The heart and soul of the venue are the two large halls - „Almaty“ on the ground floor and „Moskau“ (Moscow) on the upper level.

10 more rooms offer lots of space for workshops, lounges, buffets and much more.

To guarantee you maximum flexibility the entire venue comes without furniture and almost all rooms feature mobile partition systems, which enable easy modifications and variations.

A curtain system with blackout curtains allows to darken the rooms for projections.

Cafe Moskau includes two popular outdoor areas, which are ideal for receptions, catering and breaks outdoors.

The Atrium in the center of Cafe Moskau enables direct access to the foyers, the hall Almaty, and the rooms Jerewan (Yerevan), Duschanbe (Dushanbe) and Bischkek (Bishkek).

The Rosengarten (rose garden) with its very own charm, water feature and roses enables direct access to the rooms Asgabat, Duschanbe (Dushanbe) and Jerewan (Yerevan).

Get impressed by the charm of Cafe Moskau and arrange a site inspection with our team.



We are looking forward to welcoming you!

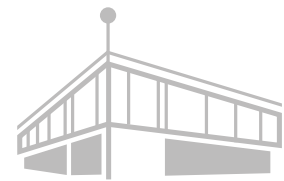

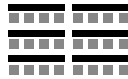

CAFE MOSKAU  
BERLIN

## MEASUREMENTS & SEATING OPTIONS

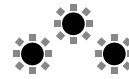
SPACE	AREA	HIGHT					LIST PRICES PER DAY*
<b>entire venue</b> incl. outdoor spaces	<b>2.596,50 m<sup>2</sup></b>						<b>21.500 €</b>
<b>Ground floor**</b>	<b>954,50 m<sup>2</sup></b>		Pax	Pax	Pax	Pax	<b>10.750 €</b>
Almaty	382 m <sup>2</sup>	3,50 m	375	182	288	230	-
Asgabat	160 m <sup>2</sup>	3,50 m	141	72	108	100	-
Duschanbe	67 m <sup>2</sup>	3,50 m	24	15	24	-	-
Jerewan	67 m <sup>2</sup>	3,50 m	20	-	-	20	-
Bischkek	81 m <sup>2</sup>	3,50 m	78	30	42	40	-
Foyer Baku	105 m <sup>2</sup>	3,50 m	-	-	-	-	-
Foyer Taschkent	73 m <sup>2</sup>	3,20 m	-	-	-	-	-
Office (up to 8 Pax)	19,50 m <sup>2</sup>	3,50 m					
<b>Upper floor**</b>	<b>1020 m<sup>2</sup></b>						<b>10.750 €</b>
Moskau	446 m <sup>2</sup>	3,90 m	433	232	378	280	-
Vilnius	66,50 m <sup>2</sup>	3,50 m	64	25	36	30	-
Tallinn	60 m <sup>2</sup>	3,50 m	46	24	30	30	-
Riga	65 m <sup>2</sup>	3,50 m	46	24	30	30	-
Minsk	88 m <sup>2</sup>	3,50 m	63	34	36	30	-
Chisinau	112 m <sup>2</sup>	3,50 m	108	-	-	-	-
Foyer Kiew	113,50 m <sup>2</sup>	3,50 m	-	-	-	-	-
Foyer Tiflis	69 m <sup>2</sup>	3,50 m	-	-	-	-	-
<b>Outdoor spaces</b>							
Rosengarten	400 m <sup>2</sup>		-	-	-	-	1.000 €
Atrium	222 m <sup>2</sup>		-	-	-	-	1.000 €
<b>Basement</b>							
Sputnik	127 m <sup>2</sup>	2,80 m	98	39	-	-	1.000 €
Club area	411,50 m <sup>2</sup>	3,00 m					6.500 €

\* 50% of the listed price is charged for set-up and dismantling days.

The maximum capacity for each floor is 800 people.

The seating numbers are benchmarks and may depend on the concept and set-up. All specifications are subject to change and have to be inspected on-site.

Additionally we charge costs for power, water, staff and cleaning. A 10 Mbit/s network (up- and download-rate of 4 Mbit/s) for internal usage is included.

All prices are net prices and are exclusive of VAT.

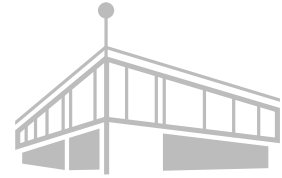

CAFE MOSKAU  
BERLIN

# FLOOR PLAN

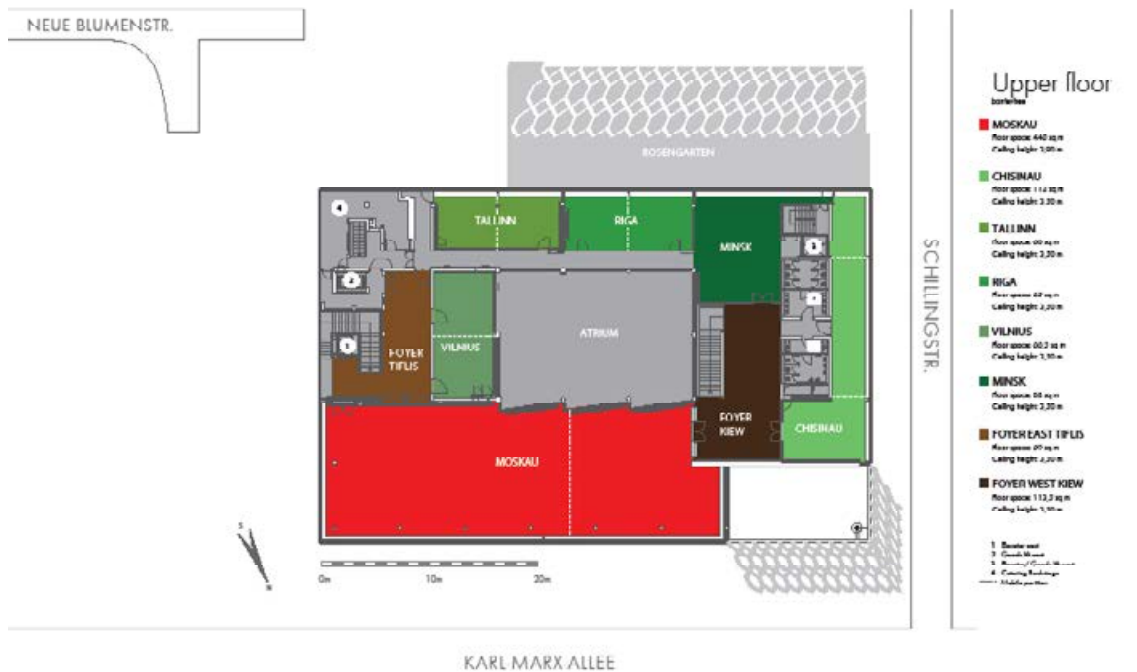
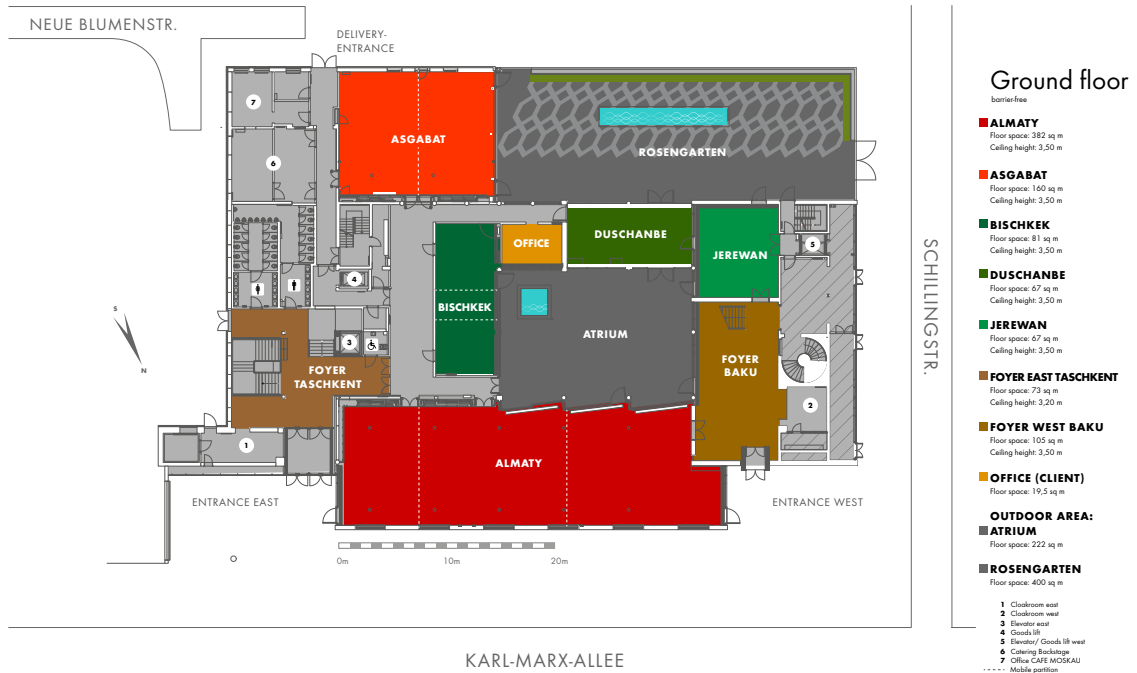

## DIVERSE SERVICES



### STAFF

We have a large network of competent, experienced service providers available to assist you in various areas. Starting from barista to barkeeper up to first aid team, photographer, hosts/hostess or security.

We are more than happy to support you with your staff planning.



### BEVERAGE PACKAGES

We offer many kinds of beverage packages whether you need a standard conference package, organic beverages or customized cocktails.

Each beverage package can be upgraded with coffee specialities. You can choose between an automatic and an Italian coffee machine with a barista who will fascinate your guests with artistic Latte Art.



### ALL-INCLUSIVE

At your request, we can handle the coordination, management and billing of partner services for event technology, food catering and equipment including decoration. A handling fee will be charged for each final order of the respective partner services.

This allows us to offer you an almost all-inclusive package as part of the venue rental.

Event conception and guests management are excluded from this service.

## DIVERSE SERVICES



### MOBILE BARSYSTEM

Our mobile bar system includes bar elements and shelves with coloured LED lights as well as fridges. All elements can be branded.



### INTERNET

All event spaces at Cafe Moskau are full Wifi-enabled (bandwidth may be upgraded from 10 Mbit/s to 1 Gbit/s (synchronously)). Let us know your needs and we'll draw up a tailor-made quote. When using the Wifi, you will be given personalised access details in advance.



### MARQUEES & CLOAKROOM

We can offer various marquee options to extend function space of Cafe Moskau. Both outdoor areas Atrium and Rosengarten can be covered using marquees. The eastern and western foyer offer enough space for a cloakroom holding up to 500 clothing items.

## OUR OTHER VENUES



TEC EVENT CAMPUS

**TEC EVENT CAMPUS** offers 4 barrier-free event spaces with daylight.

The biggest space is Main Hall with 834 m<sup>2</sup> und capacity of 800 seats in theatre style.

The old viadukt of the Siemens railway gives the large outdoor spaces it's own charme.

### Keyfacts

**TEC-EVENT-CAMPUS.COM**

**Address:** Wohlrabedamm 7  
13629 Berlin

- 1.400 m<sup>2</sup> event space
- 5.000 m<sup>2</sup> outdoor space
- Parking facility for up 60 vehicles
- capacity for 1.000 Pax
- permissible floor load of 1.5 t per m<sup>2</sup>
- free of furniture, AV and food catering



### SALON BABETTE

The former beauty salon „Babette“ is a multifunctional venue with two levels, a fixed bar, lounge furniture and event technology.

SALON BABETTE  
BERLIN



**SALONBABETTE.COM**

**Address:** Karl-Marx-Allee 36  
10178 Berlin

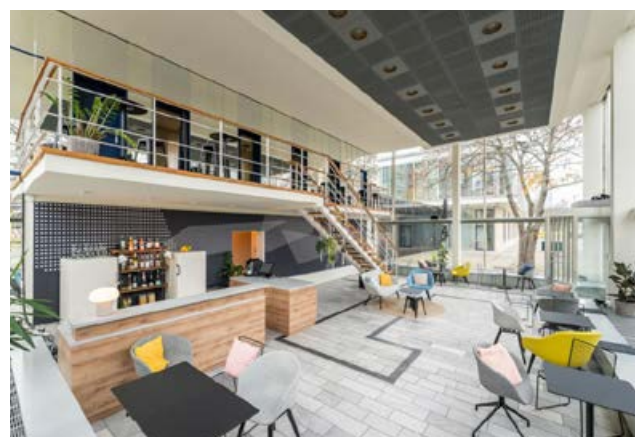



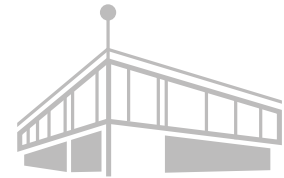

CAFE MOSKAU  
BERLIN

## CONTACT & PARTNER

### LOCATION

Cafe Moskau  
Karl-Marx-Allee 34  
10178 Berlin

### DELIVERIES

Neue Blumenstraße 13

### OFFICE

Cafe Moskau GmbH  
Milastraße 2  
10437 Berlin

### ENQUIRIES & VISITS

Sales Team  
Fon +49.30.470 807 77  
event@cafemoskau.com

### EVENT ORGANISATION & QUESTIONS CONCERNING PRODUCTION

Production Team  
produktion@cafemoskau.com

### SECURITY

FSB-Security  
Jörn Ullmann  
joern.ullmann@fsb-security.com

### FURNITURE & DECORATION

Party.Rent Berlin  
Katharina Riedesel  
Fon +49.30.200 061 513 7  
katharina.riedesel@partyrent.com

### EVENT TECHNOLOGY

AMBION GmbH  
Christian Rathgeber-Fietzke  
& Marc Dyrzcz  
Fon +49.30.726 278 412 1  
cafemoskau@ambion.de

### CATERING

Einhorn Restorations GmbH  
Bernhard Braig  
Fon +49.30.343 354 0  
bernhard.braig@einhorn-catering.de

Fuchs + Gans GmbH  
Gernot Karger & Paula Möhring  
Fon +49.30.804 935 69  
info@fuchsundgans.com

### HOTEL

Amano Group  
up to 10 rooms – Izabella Lugin  
lugin@amanogroup.com

10+ rooms – Monique Belling  
belling@amanogroup.com

### DRIVER SERVICE

BerlinMobil Frank Richert GmbH  
Doreen Plischkaner  
Fon +49.30.422 199 14  
plischkaner@berlinmobil.de

Hoflieferanten Berlin  
Michael Lammert  
Fon +49.30.200 086 611  
lammert@hoflieferanten.berlin

Kochbox-Event Berlin GmbH  
Katharina Müller  
Fon +49.30.857 426 16  
info@kochbox.com

Wild & Wiese GmbH & Co. KG  
Ralf Dekorsy  
Fon +49.30.657 779 01  
ralf.dekorsy@wildundwiese.de

## LOCATION & ARRIVAL

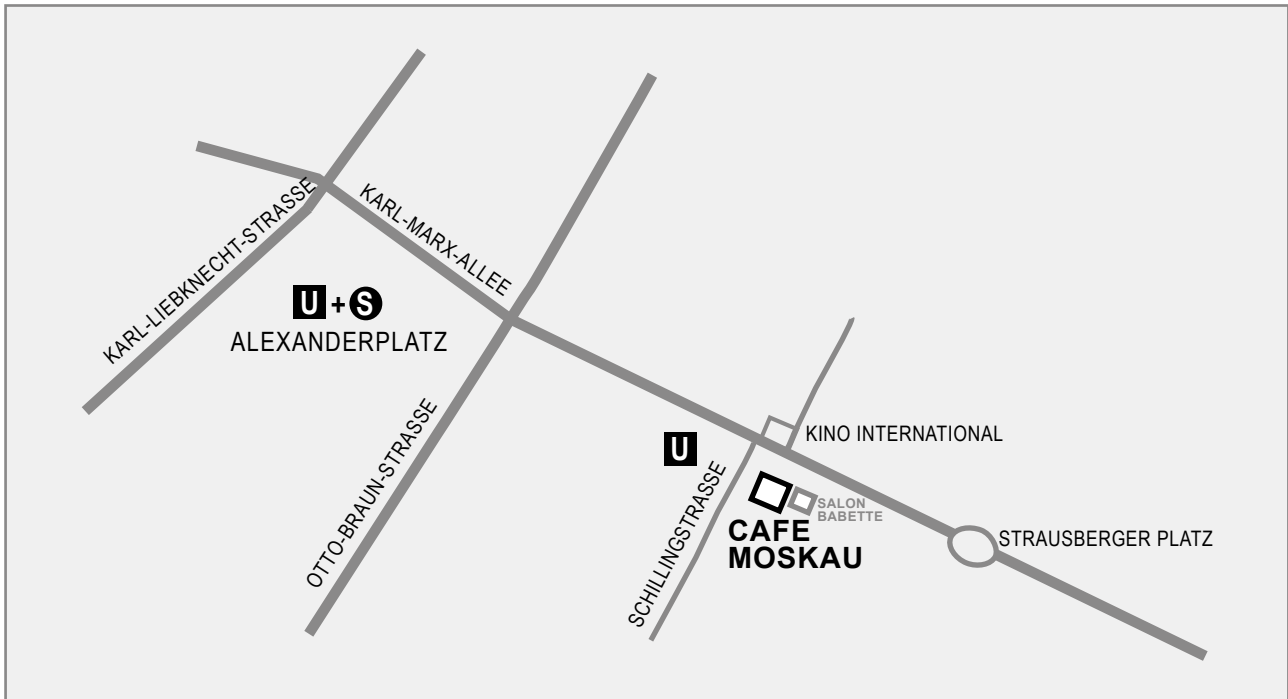

Cafe Moskau is located in Berlin-Mitte, a five minute walk from Alexanderplatz and directly in front of underground station Schillingstraße.

### **PUBLIC TRANSPORTATION**

From Alexanderplatz: underground line U5 to Schillingstraße

From Hauptbahnhof (main station): underground line U5 to Schillingstraße

From airport BER: Regional trains FEX/ RE7/ RB 14 to Hauptbahnhof (main station), underground line U5 to Schillingstraße

### **PARKING**

There is sufficient public parking available.