

NEUE BLUMENSTR.

DELIVERY-
ENTRANCE



Ground floor

barrier-free

- **ALMATY**
Floor space: 382 qm
Height: 3,50 m
- **ASGABAT**
Floor space: 160 qm
Height: 3,50 m
- **BISCHKEK**
Floor space: 81 qm
Height: 3,50 m
- **DUSCHANBE**
Floor space: 67 qm
Height: 3,50 m
- **JEREWAN**
Floor space: 67 qm
Height: 3,50 m
- **FOYER OST TASCHKENT**
Floor space: 73 qm
Height: 3,20 m
- **FOYER WEST BAKU**
Floor space: 105 qm
Height: 3,50 m
- **FOYER CLUB**
Floor space: 81,3 qm
Height: 3,70 m
- **OFFICE (CLIENT)**
Floor space: 73 qm
Height: 3,20 m
- **OUTDOOR AREAS:**
ATRIUM
Floor space: 222 qm
- ROSENGARTEN**
Floor space: 400 qm

SCHILLINGSTR.

KARL-MARX-ALLEE

- 1** Cloakroom east
- 2** Cloakroom west
- 3** Elevator
- 4** Goods lift
- 5** Elevator/Goods lift
- 6** Catering backstage
- 7** Office CAFE MOSKAU
- - - - Mobile partition

NEUE BLUMENSTR.

Upper floor

barrier-free

MOSKAU
Floor space: 446 qm
Height: 3,90 m

CHISINAU
Floor space: 112 qm
Height: 3,50 m

TALLINN
Floor space: 60 qm
Height: 3,50 m

RIGA
Floor space: 65 qm
Height: 3,50 m

VILNIUS
Floor space: 66,5 qm
Height: 3,50 m

MINSK
Floor space: 88 qm
Height: 3,50 m

FOYER OST TIFLIS
Floor space: 69 qm
Height: 3,50 m

FOYER WEST KIEW
Floor space: 113,5 qm
Height: 3,50 m

- 1 Elevator
- 2 Goods lift
- 3 Elevator/ Goods lift
- 4 Catering backstage
- Mobile partition

SCHILLINGSTR.



KARL-MARX-ALLEE

NEUE BLUMENSTR.

Basement

barrier-free

■ SPUTNIK

Floor space: 127 qm
Height: 2,80 m

■ FOYER

Floor space: 60,6 qm
Height: 2,75 m

■ CLUB

Teil 1
Floor space: 345,5 qm
Height: 3 m

Teil 2
Floor space: 66 qm
Height: 2,65 m

- 1 Elevator/ Goods lift
- 2 Cloakroom
- 3 Platforms
- 4 Catering backstage
- 5 Corridors backstage
- 6 Goods lift
- 7 Elevator

SCHILLINGSTR.

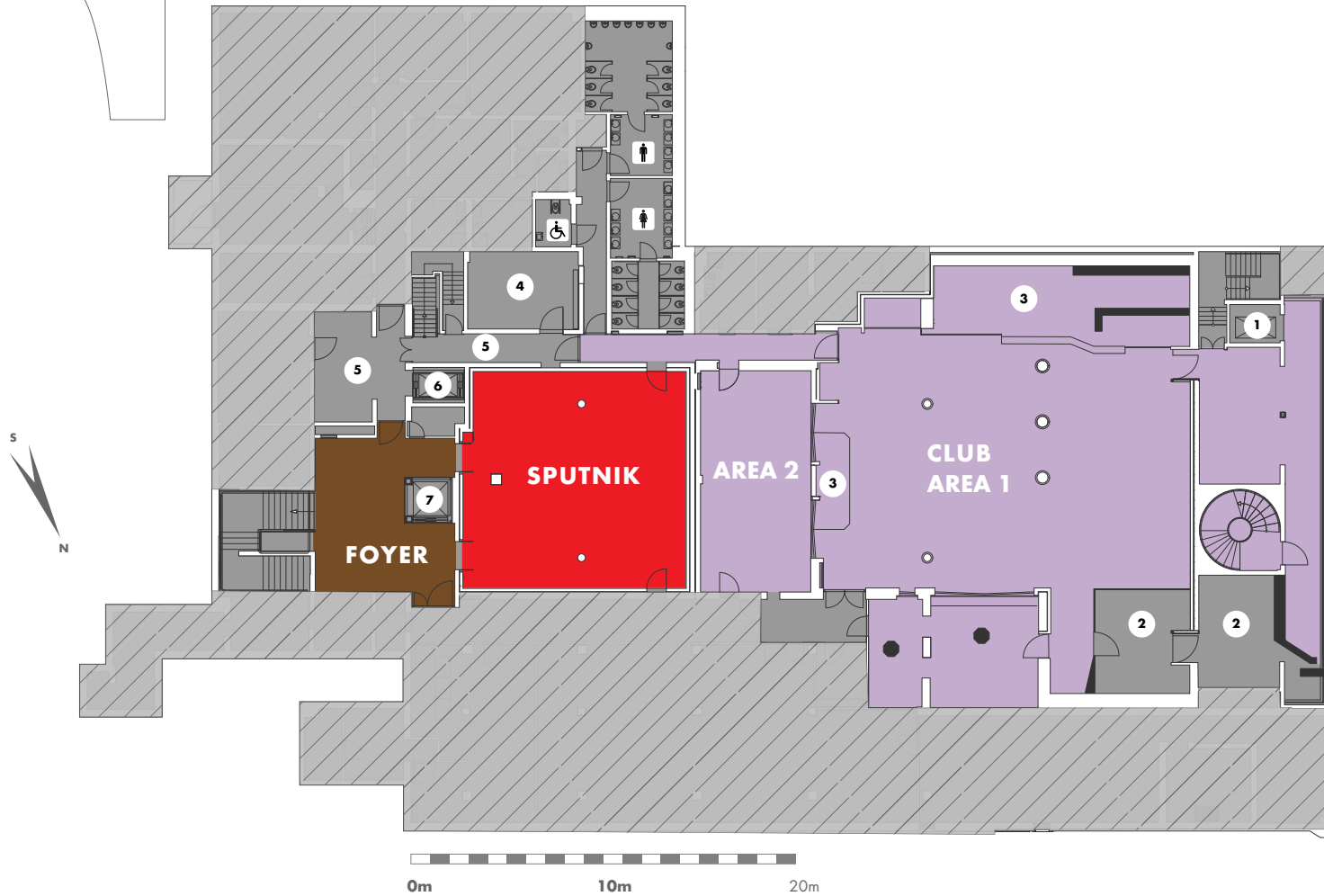

KARL-MARX-ALLEE