

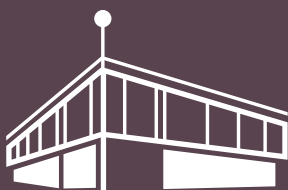

**CLUB AREA**  
in the basement of Cafe Moskau



**CAFE MOSKAU**  
BERLIN

Fon: +49.30.412 074 78  
event@cafemoskau.com

Cafe Moskau  
Karl-Marx-Allee 34  
10178 Berlin  
[www.cafemoskau.com](http://www.cafemoskau.com)



## EVENT SPACES



During the GDR era, the “Georgian Night Bar” was a magnet for partygoers – disco beats, solo entertainers, and a bottle of Bordeaux for 60 East German marks included.

After the reunification of Germany, the club area was transformed into a party venue; renowned DJs such as Paul van Dyk performed here.

Elements of the current design concept and spatial layout were created by the architectural firm studio karhard®, which designed the club area in 2013 for the tenant at the time. These include wall elements woven from stainless steel and brass, as well as wooden reliefs and engraved wall patterns inspired by the concrete honeycomb structure of the outdoor space Rosengarten.

Today, the refurbished spaces serve as versatile event areas – unfurnished, technically flexible, and steeped in history. Two entrances (via Baku foyer or Schillingstraße) and a permanently installed cloakroom ensure a convenient arrival – everything else is a stage for individual ideas.



## EVENT SPACES



**Part 1 of the club area** forms the heart of our basement spaces – woven metal strips, light boxes, and a tubular light installation give the room its distinctive club atmosphere. A counter on a raised, separate section of the space can be used as a bar. A platform at the far end of the room can serve as a stage for a DJ or speaker, depending on the concept.



**Part 2 of the club area** is accessible via the corridor or from the “Hirschraum” (room with a deer wall mosaic). Versatile in its use, this space can host dinners, lounge areas, or workshops. Thanks to a one-way mirror wall opposite the tiled wall, guests can keep an eye on what’s going on in Part 1 of the club area at all times.



The **„Hirschraum“**, made up of two sections featuring industrial-style light columns, is directly connected to Part 1 of the club area. Here too, a one-way mirror wall offers views into the adjoining space. The room owes its name to a wall mosaic from a herbal liqueur producer – a relic from times past.

## SEATING OPTIONS



150 seats



210 seats



130 seats

## RENTAL COSTS

LOCATION	MIETZEITRAUM	LISTENPREIS	DETAILS
Clubbereich	11 Uhr bis 8 Uhr am Folgetag	8.500 €* 	<ul style="list-style-type: none"> <li>– maximale Kapazität – 800 Personen</li> <li>– inkl. Catering Backbereich sowie Lagerraum</li> <li>– inkl. Internet für internen Gebrauch (up- &amp; download 4 Mbit/s)</li> </ul>

\*Auf- und Abbautage werden mit 50% des Listenpreises berechnet.

Alle Preise verstehen sich zuzüglich Mehrwertsteuer. Kosten für Strom, Wasser, Personal sowie Reinigung werden zusätzlich berechnet.

## FOYERS AND OTHER SPACES



**Foyer club (ground floor)** – access via Schillingstraße  
or Baku foyer of the rentals space of Cafe Moskau



**Cloakroom (basement)** – capacity for 800 pieces



**Staircase (ground floor ↔ basement)** – access via  
club foyer (ground floor)



**Hallway & foyer (basement)**



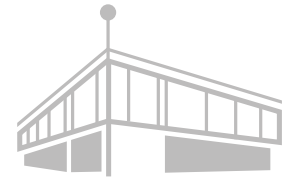

CAFE MOSKAU  
BERLIN

# FLOOR PLAN

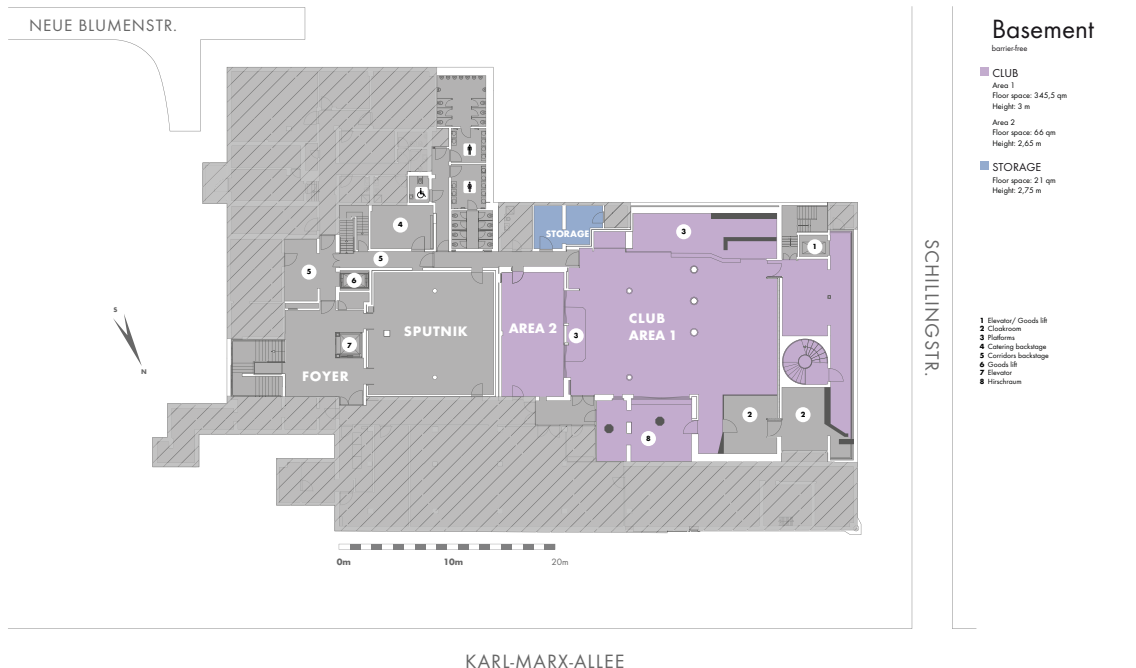

KARL-MARX-ALLEE

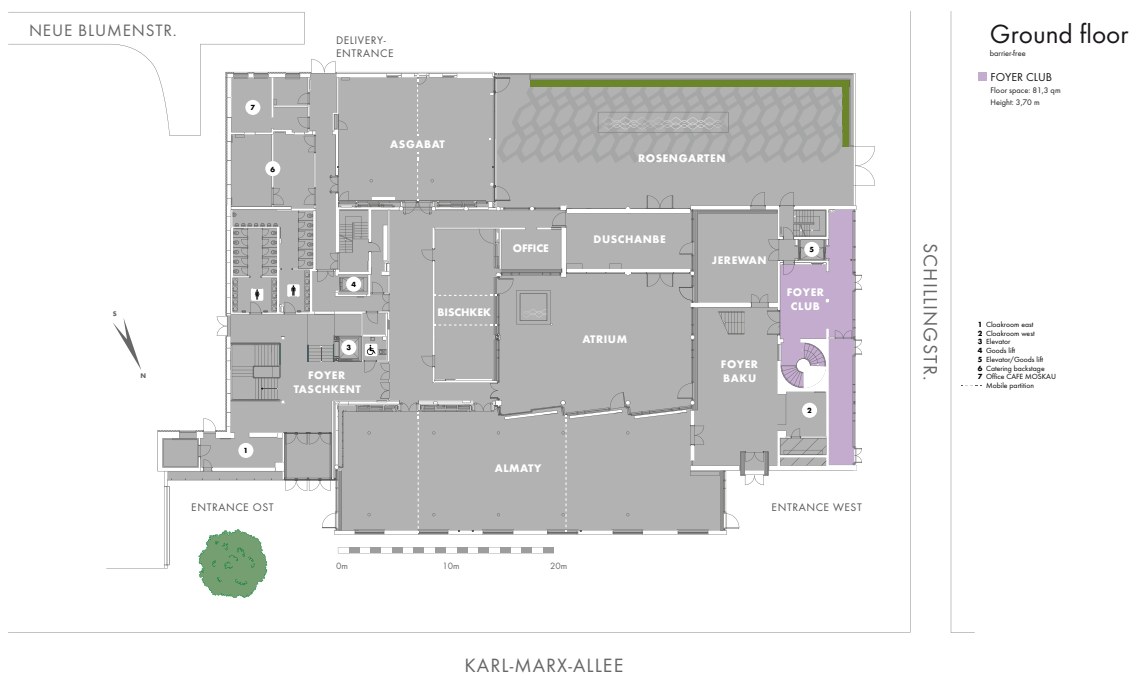

KARL-MARX-ALLEE

## CONTACT & PARTNERS

### VENUE

Club area at Cafe Moskau  
Karl-Marx-Allee 34  
10178 Berlin

### DELIVERIES

Neue Blumenstraße 13

### OFFICE

Cafe Moskau GmbH  
Milastraße 2  
10437 Berlin

### ENQUIRIES & VISITS

Sales Team  
Fon +49.30.470 807 77  
event@cafemoskau.com

### EVENT ORGANISATION & QUESTIONS CONCERNING PRODUCTION

Produktion Team  
produktion@cafemoskau.com

### SECURITY

FSB-Security  
Jörn Ullmann  
joern.ullmann@fsb-security.com

### FURNITURE & DECORATION

Party.Rent Berlin  
Juliane Seidel  
Fon +49.30.200 061 525 8  
juliane.seidel@partyrent.com

### EVENT TECHNOLOGY

AMBION GmbH  
Christian Rathgeber-Fietzke  
& Lars Hiesener  
Fon +49.30.726 278 412 1  
cafemoskau@ambion.de

## OUR VENUES

SALON BABETTE  
BERLIN



CAFE MOSKAU  
BERLIN



TEC EVENT CAMPUS

## LOCATION & ARRIVAL

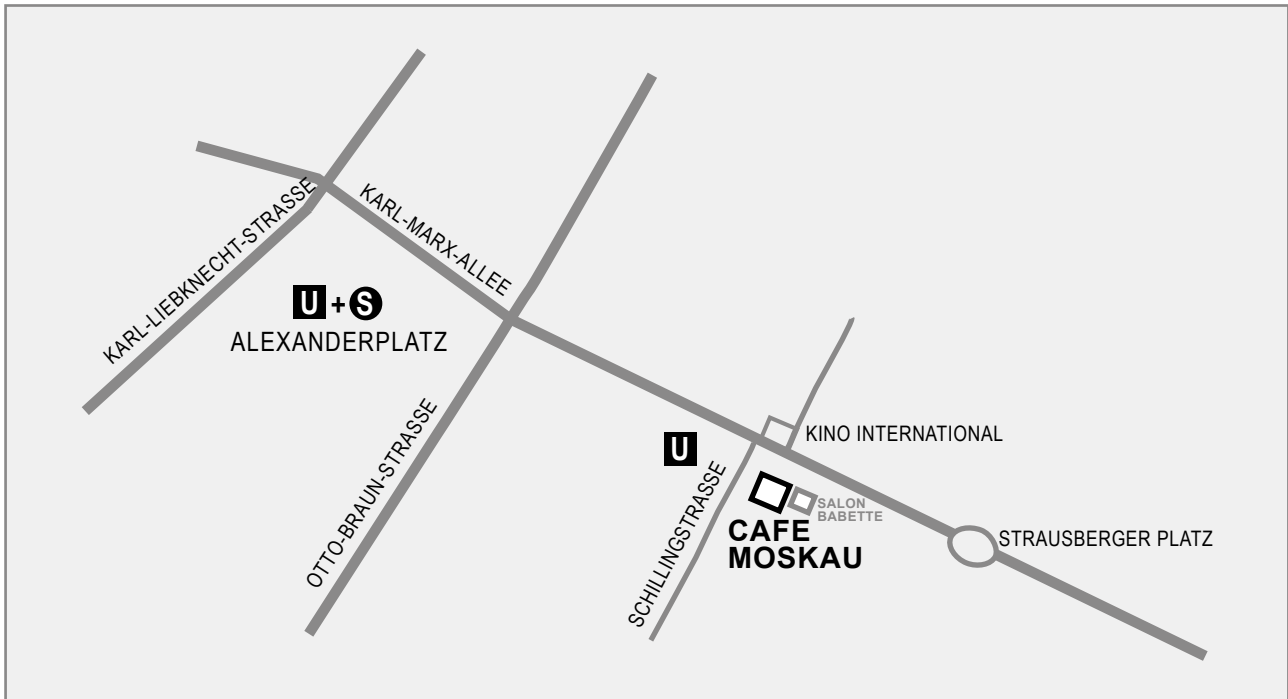

Cafe Moskau is located in Berlin-Mitte, a five minute walk from Alexanderplatz and directly opposite the underground station Schillingstraße.

### PUBLIC TRANSPORTATION

From Alexanderplatz: underground line U5 to Schillingstraße

From Hauptbahnhof (main station): underground line U5 to Schillingstraße

From airport BER: Regional trains FEX/ RE7/ RB14 to Hauptbahnhof (main station), underground line U5 to Schillingstraße

### PARKING

There is sufficient public parking available.