



CLUB AREA
in the basement of Cafe Moskau



CAFE MOSKAU
BERLIN

Fon: +49.30.412 074 78
event@cafemoskau.com

Cafe Moskau
Karl-Marx-Allee 34
10178 Berlin
www.cafemoskau.com

EVENT SPACES



During the GDR era, the “Georgian Night Bar” was a magnet for partygoers – disco beats, solo entertainers, and a bottle of Bordeaux for 60 East German marks included.

After the reunification of Germany, the club area was transformed into a party venue; renowned DJs such as Paul van Dyk performed here.

Elements of the current design concept and spatial layout were created by the architectural firm studio karhard®, which designed the club area in 2013 for the tenant at the time. These include wall elements woven from stainless steel and brass, as well as wooden reliefs and engraved wall patterns inspired by the concrete honeycomb structure of the outdoor space Rosengarten.

Today, the refurbished spaces serve as versatile event areas – unfurnished, technically flexible, and steeped in history. Two entrances (via Baku foyer or Schillingstraße) and a permanently installed cloakroom ensure a convenient arrival – everything else is a stage for individual ideas.



EVENT SPACES



Part 1 of the club area forms the heart of our basement spaces – woven metal strips, light boxes, and a tubular light installation give the room its distinctive club atmosphere. A counter on a raised, separate section of the space can be used as a bar. A platform at the far end of the room can serve as a stage for a DJ or speaker, depending on the concept.



Part 2 of the club area is accessible via the corridor or from the “Hirschraum” (room with a deer wall mosaic). Versatile in its use, this space can host dinners, lounge areas, or workshops. Thanks to a one-way mirror wall opposite the tiled wall, guests can keep an eye on what’s going on in Part 1 of the club area at all times.



The **„Hirschraum“**, made up of two sections featuring industrial-style light columns, is directly connected to Part 1 of the club area. Here too, a one-way mirror wall offers views into the adjoining space. The room owes its name to a wall mosaic from a herbal liqueur producer – a relic from times past.

SEATING OPTIONS



150 seats



210 seats



130 seats

RENTAL COSTS

LOCATION	RENTAL PERIOD	LIST PRICE	DETAILS
Club area	11 pm until 8 am the following day	8.500 €* 	<ul style="list-style-type: none"> – max. capacity – 800 people – incl. catering backstage and storage – incl. Internet for internal usage (up- & download 4 Mbit/s)

*** We offer exclusive discounts on last-minute bookings and during the off-season.**
Set-up and dismantling days: 50% of the price.

All prices are net prices and are exclusive of VAT. Additionally we charge costs for power, water, staff and cleaning.

FOYERS AND OTHER SPACES



Foyer club (ground floor) – access via Schillingstraße
or Baku foyer of the rentals space of Cafe Moskau



Cloakroom (basement) – capacity for 800 pieces



Staircase (ground floor <=> basement) – access via
club foyer (ground floor)



Hallway & foyer (basement)

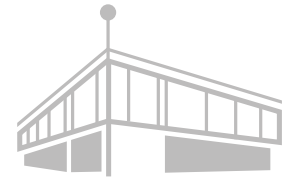

CAFE MOSKAU
BERLIN

FLOOR PLAN

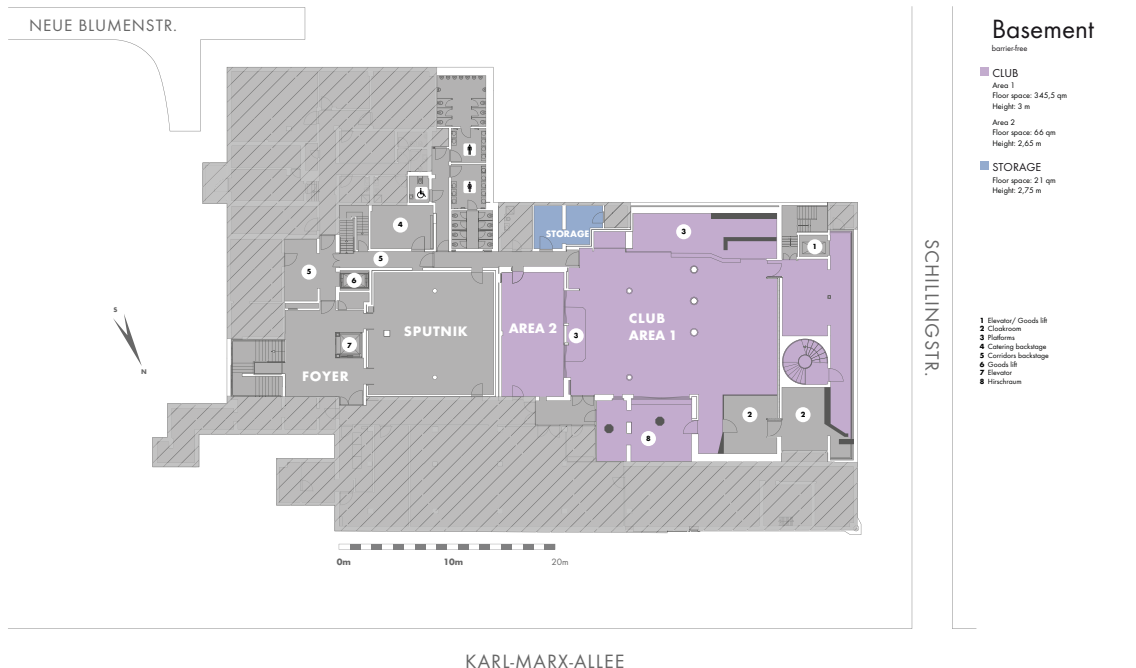

KARL-MARX-ALLEE

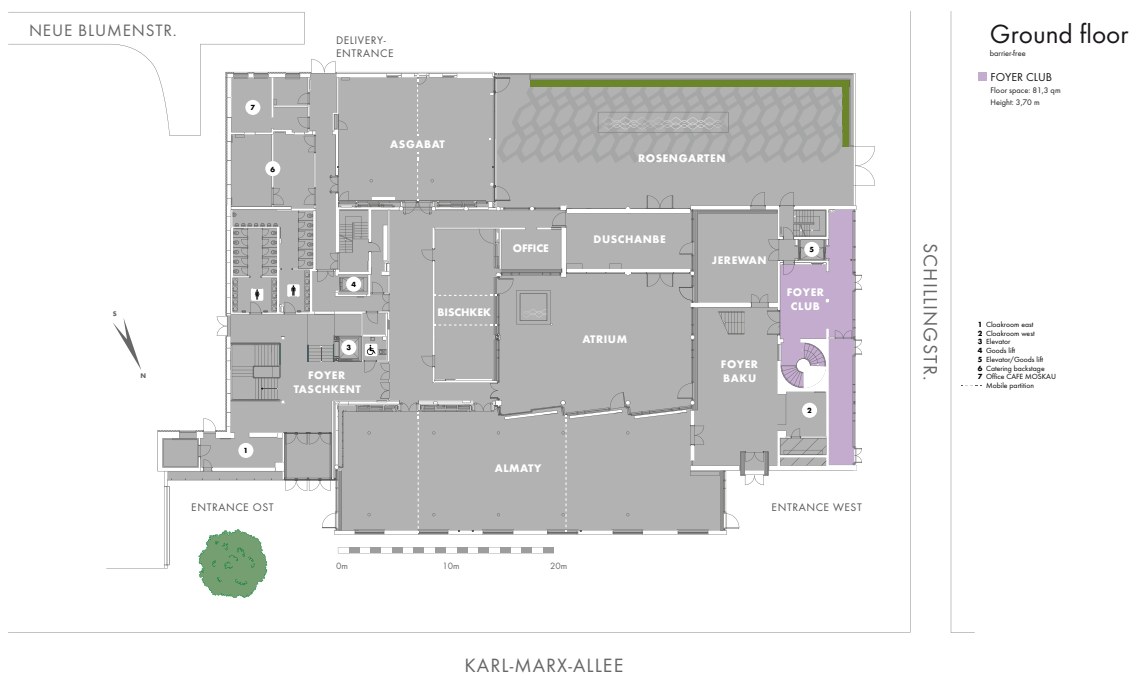

KARL-MARX-ALLEE

CONTACT & PARTNERS

VENUE

Club area at Cafe Moskau
Karl-Marx-Allee 34
10178 Berlin

DELIVERIES

Neue Blumenstraße 13

OFFICE

Cafe Moskau GmbH
Milastraße 2
10437 Berlin

ENQUIRIES & VISITS

Sales Team
Fon +49.30.470 807 77
event@cafemoskau.com

EVENT ORGANISATION & QUESTIONS CONCERNING PRODUCTION

Produktion Team
produktion@cafemoskau.com

SECURITY

FSB-Security
Jörn Ullmann
joern.ullmann@fsb-security.com

FURNITURE & DECORATION

Party.Rent Berlin
Juliane Seidel
Fon +49.30.200 061 525 8
juliane.seidel@partyrent.com

EVENT TECHNOLOGY

AMBION GmbH
Christian Rathgeber-Fietzke
& Lars Hiesener
Fon +49.30.726 278 412 1
cafemoskau@ambion.de

CATERING

Fuchs + Gans GmbH
Gernot Karger & Paula Möhring
Fon +49.30.804 935 69
info@fuchsundgans.com

Hoflieferanten Berlin
Michael Lammert
Fon +49.30.200 086 611
lammert@hoflieferanten.berlin

Kochbox-Event Berlin GmbH
Katharina Müller
Fon +49.30.857 426 16
info@kochbox.com

Wild & Wiese GmbH & Co. KG
Ralf Dekorsy
Fon +49.30.657 779 01
ralf.dekorsy@wildundwiese.de

OUR VENUES

**SALON BABETTE
BERLIN**



**CAFE MOSKAU
BERLIN**



TEC EVENT CAMPUS

LOCATION & ARRIVAL

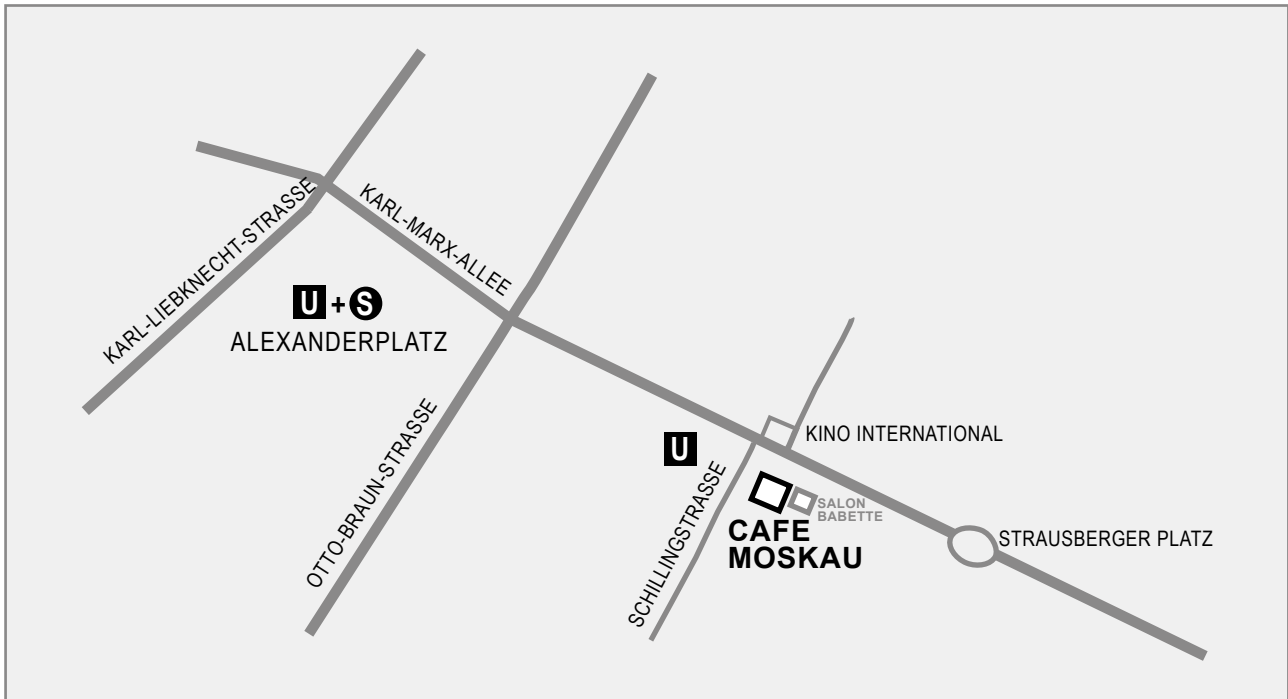

Cafe Moskau is located in Berlin-Mitte, a five minute walk from Alexanderplatz and directly opposite the underground station Schillingstraße.

PUBLIC TRANSPORTATION

From Alexanderplatz: underground line U5 to Schillingstraße

From Hauptbahnhof (main station): underground line U5 to Schillingstraße

From airport BER: Regional trains FEX/ RE7/ RB14 to Hauptbahnhof (main station), underground line U5 to Schillingstraße

PARKING

There is sufficient public parking available.