

NEUE BLUMENSTR.

DELIVERY-
ENTRANCE



Ground floor

barrier-free

■ ALMATY

Floor space: 382 sq m
Ceiling height: 3,50 m

■ ASGABAT

Floor space: 160 sq m
Ceiling height: 3,50 m

■ BISCHKEK

Floor space: 81 sq m
Ceiling height: 3,50 m

■ DUSCHANBE

Floor space: 67 sq m
Ceiling height: 3,50 m

■ JEREWAN

Floor space: 67 sq m
Ceiling height: 3,50 m

■ FOYER EAST TASCHKENT

Floor space: 73 sq m
Ceiling height: 3,20 m

■ FOYER WEST BAKU

Floor space: 105 sq m
Ceiling height: 3,50 m

OUTDOOR AREA:

■ ATRIUM

Floor space: 222 sq m

■ ROSENGARTEN

Floor space: 400 sq m

- 1 Cloakroom east
- 2 Cloakroom west
- 3 Elevator east
- 4 Goods lift
- 5 Elevator/ Goods lift west
- 6 Catering Backstage
- 7 Office CAFE MOSKAU
- 8 Production office
- - - - Mobile partition

SCHILLINGSTR.

KARL-MARX-ALLEE

NEUE BLUMENSTR.



Upper floor

barrier-free

- MOSKAU**
Floor space: 446 sq m
Ceiling height: 3,90 m
- CHISINAU**
Floor space: 112 sq m
Ceiling height: 3,50 m
- TALLINN**
Floor space: 60 sq m
Ceiling height: 3,50 m
- RIGA**
Floor space: 65 sq m
Ceiling height: 3,50 m
- VILNIUS**
Floor space: 66,5 sq m
Ceiling height: 3,50 m
- MINSK**
Floor space: 88 sq m
Ceiling height: 3,50 m
- FOYER EAST TIFLIS**
Floor space: 69 sq m
Ceiling height: 3,50 m
- FOYER WEST KIEW**
Floor space: 113,5 sq m
Ceiling height: 3,50 m

- 1 Elevator east
- 2 Goods lift east
- 3 Elevator/ Goods lift west
- 4 Catering Backstage
- Mobile partition

SCHILLINGSTR.

KARL-MARX-ALLEE

NEUE BLUMENSTR.

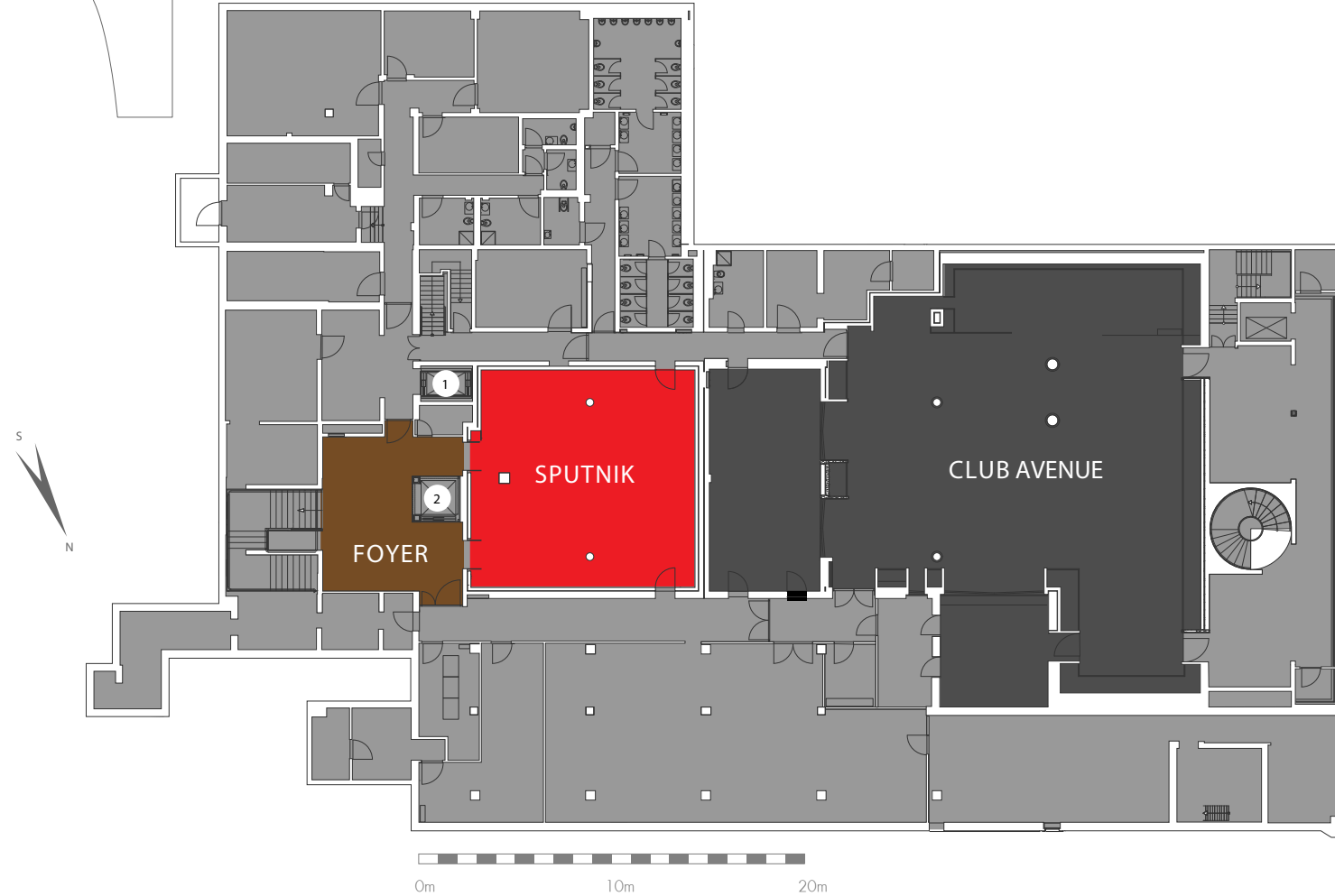

Basement

barrier-free

SPUTNIK
Floor space: 127 sq m
Ceiling height: 2,80 m

FOYER
Floor space: 60,6 sq m
Ceiling height: 2,75 m

CLUB AVENUE

1 Goods lift
2 Elevator

SCHILLINGSTR.

KARL-MARX-ALLEE